

*Dock Your Tablets with the One and Only...*

# ReadyDock™-LE

## ReadyDock™-LE stands alone in today's marketplace

ReadyDock was introduced to the marketplace last year and quickly captured the interest of major health care clinics throughout the United States.

This popular storage and charging unit is now available for the Motion Computing LE Series Tablets.

This attractive piece of furniture not only provides necessary storage and charging but also adds to the aesthetics of your office. They are available in a variety of configurations suitable for 5, 10, 15, or 20 tablets.

Good news for owners of the original ReadyDock. The new modules are the same size and can be integrated with your current unit.

Each case is constructed of quality maple hardwood and wood grain laminate.



*ReadyDock™-LE  
RD5-LE — Single Unit  
16 1/2" W x 20 1/4" D x 22 5/8" H*

### **Benefits:**

- Centralized Tablet Storage
- Centralized Tablet Management
- Securely locked cases
- Aesthetically pleasing furniture
- Eliminates messy power supply set up

### **Features:**

- Custom power contacts charge Tablet PC automatically, once inserted
- Orange light notifies you Tablet is charging
- Green light tells you Tablet is fully charged
- Precision fit for easy docking
- Choice of configuration to fit any setting

**For more information or to order ReadyDock-LE contact:**



Advanced Technical Support, Inc.  
10 Grassmere Avenue  
West Hartford, CT 06110

Phone: 800-969-1166  
Fax: 860-523-9511  
[www.atsworldwide.com](http://www.atsworldwide.com)

Email inquiries to Nancy Hansen: [nhansen@atsworldwide.com](mailto:nhansen@atsworldwide.com)

**ReadyDock™-LE Configurations and Specifications shown on next page.**

# ReadyDock-LE™

## Docking Station Configurations

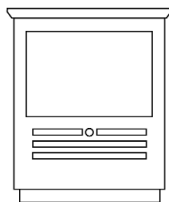
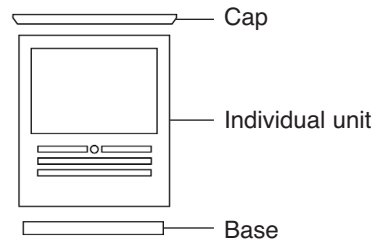

**RD5-LE** Single Unit

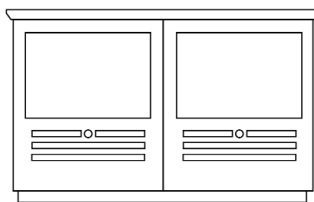

**RD10H-LE** Double, Side By Side

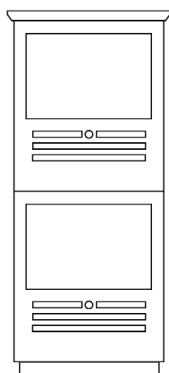

**RD10V-LE** Double Stack

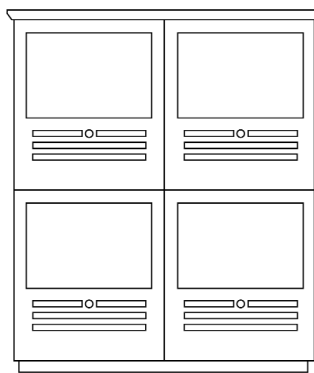

**RD20-LE** Four Stack

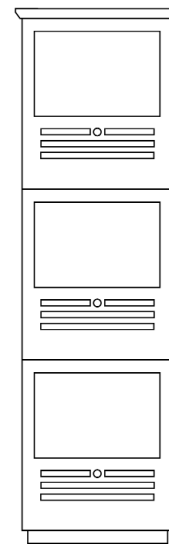

**RD15V-LE** Triple Stack

Model No.	Description	Dimensions
<b>RD5-LE</b>	Single Unit	16-1/2" W X 20-1/4" D X 22-5/8" H
<b>RD10V-LE</b>	Double Stack	16-1/2" W X 20-1/4" D X 41-1/8" H
<b>RD15V-LE</b>	Triple Stack	16-1/2" W X 20-1/4" D X 59-5/8" H
<b>RD10H-LE</b>	Double, Side By Side	31-1/2" W X 20-1/4" D X 22-5/8" H
<b>RD20-LE</b>	Four Stack	31-1/2" W X 20-1/4" D X 41-1/8" H

For more information or to order ReadyDock-LE contact:



Advanced Technical Support, Inc.  
10 Grassmere Avenue  
West Hartford, CT 06110

Phone: 800-969-1166  
Fax: 860-523-9511  
[www.atsworldwide.com](http://www.atsworldwide.com)

Email inquiries to Nancy Hansen: [nhansen@atsworldwide.com](mailto:nhansen@atsworldwide.com)